

VILLAGE OF SCHAUMBURG, ILLINOIS

OFFICIAL STREET MAP 1964

SCALE: 2 1/2 INCHES TO 1 MILE

TELEPHONE NO. 529-7350

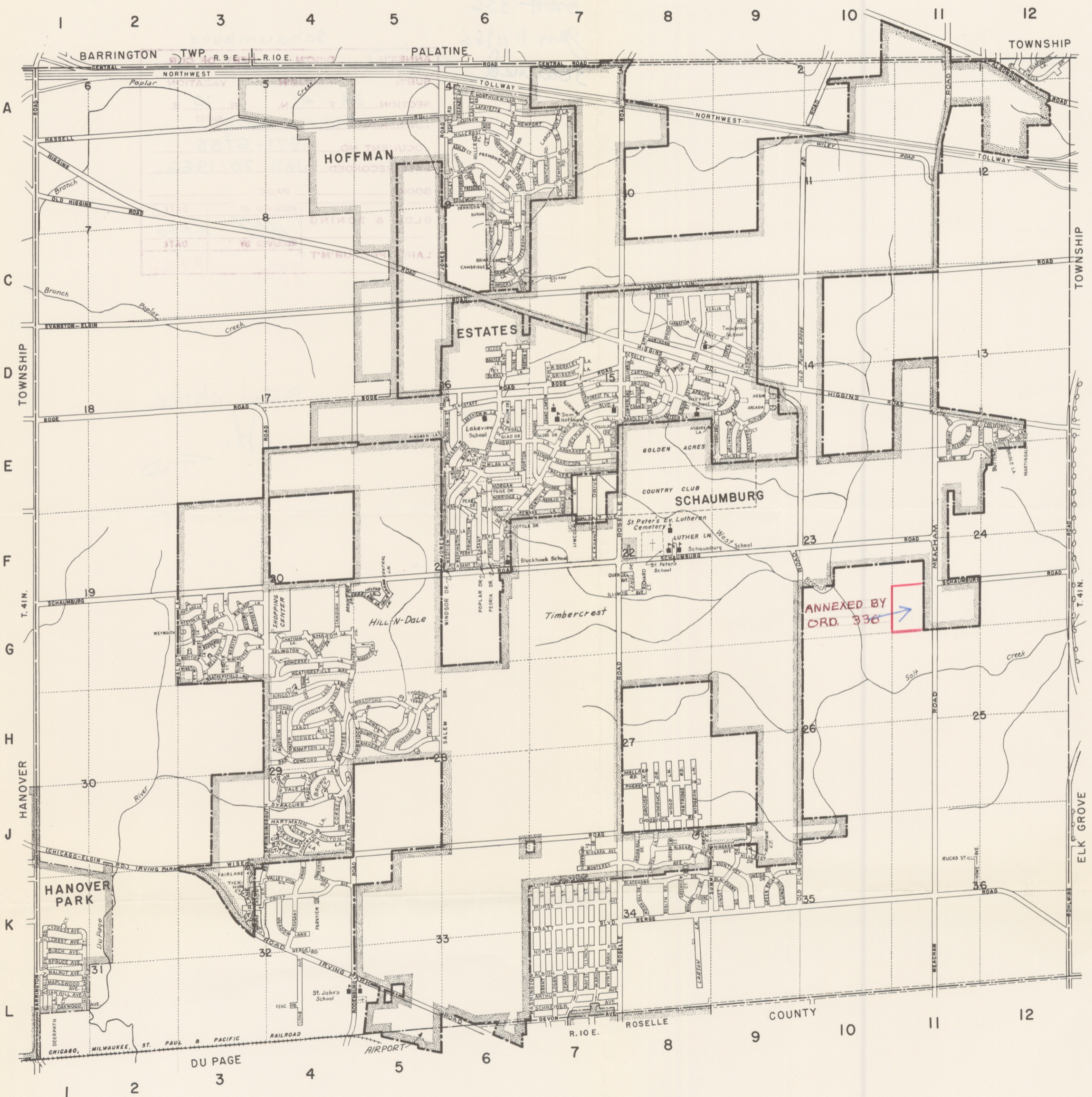

STREET INDEX

ALGONQUIN RD.	12A	OLD PLUM GROVE RD.	9K
AMHERST CT.	5H	OLEANDER DR.	11E
AMHERST LN.	5H	ORLEANS LN.	4H
ARLINGTON LN.	4G	PLEASANT DR.	7F
AUBURN CIR.	4H	PLYMOUTH LN.	4H
AUBURN LN.	4H	PRINCETON CT.	4J
AVON CT.	3K	PRINCETON LN.	4J
BATES CT.	4J	QUINDEL AV.	8G
BATES LN.	4J	RADCLIFFE LN.	4J
BODE RD.	5D	RICHARD CT.	8G
BOURNE LN.	5H	RODENBURG RD.	4L
BRADFORD CT.	5H	ROSELLE RD.	7L
BRADFORD LN.	5H	ROSELLE DR.	6H
BRAINTREE DR.	5G	SCHAUMBURG RD.	1F
BREWSTER LN.	4H	SHARON LN.	4G
BRIDLE LN.	12F	SOMERSET CT.	4G
BROWN CT.	4J	SOMERSET LN.	4G
BUTTERCUP LN.	12E	SPRINGSGUTH RD.	3J
CABOT LN.	4H	STANDISH LN.	4G
CAMBRIDGE DR.	5H	SUMMIT DR.	8K
CAMELLIA LN.	12E	SYRACUSE LN.	4J
CARVER LN.	4G	THORNEY LEA TER.	5H
CENTRAL RD.	7A	THORNWOOD DR.	7K
CHARLENE LN.	5G	TICKNOR CT.	3K
CHATHAM CT.	4G	VALLEY VIEW DR.	3K
CHATHAM LN.	4G	WABAN CT.	3G
CHICAGO - ELGIN RD.	1J	WABAN LN.	3G
CIVIC DR.	4G	WAKEFIELD LN.	5G
COLBY LN.	4J	WALNUT AV.	7F
COLUMBINE CIR.	11E	WAREHAM LN.	3G
COLUMBINE DR.	12E	WARWICK CT.	3G
CONCORD LN.	4H	WARWICK LN.	3G
CORNELL LN.	4J	WAVELLEY LN.	3G
COUNTRY CLUB LN.	4J	WAYLAND CT.	3G
CREST AV.	4K	WAYLAND LN.	3G
CREST CT.	8K	WEATHERSFIELD WAY	3G
CREST ST.	8K	WEBSTER CT.	3G
DARTMOUTH LN.	4H	WEBSTER LN.	3G
DEDHAM LN.	4H	WEDGEWOOD LN.	3G
EVANSTON - ELGIN RD.	1C	WELLESLEY CT.	3G
FAIRLANE CT.	3K	WELLESLEY LN.	3G
FAIRLANE DR.	3K	WESTON LN.	3G
FAIRVIEW CT.	5H	WESTOVER CT.	3G
FAIRVIEW LN.	5H	WESTOVER LN.	3G
FALMOUTH LN.	4H	WEYERS CT.	3K
GRAND CENTRAL CT.	5G	WEYMOUTH CT.	3G
GREENVIEW CT.	8K	WEYMOUTH LN.	3G
HAMPTON LN.	4H	WHITTIER CT.	3G
HARTMANN DR.	4J	WHITTIER LN.	3G
HARVARD CIR.	4J	WILEY RD.	10B
HARVARD LN.	4J	WILLOW RD.	11F
HELENE LN.	5G	WILTON LN.	3G
HIGGINS RD.	10E	WINCHESTER CT.	3G
ILLINOIS AV.	8G	WINCHESTER LN.	3G
INDIAN HILL DR.	8K	WINSTON LN.	3G
IRVING PARK RD.	2J	WINTHROP CT.	3G
JONES RD.	5C	WINTHROP LN.	3G
KINGHAM CT.	5H	WISE RD.	3J
KINGHAM LN.	5H	YALE LN.	4J
KINGSTON CT.	4H		
KINGSTON LN.	4H		
LAUREL LN.	8K		
LENG DR.	8G		
LELA LN.	5G		
LEXINGTON DR.	11E		
LINCOLN ST.	7F		
LOWELL CIR.	5H		
LOWELL LN.	5H		
LUTHER LN.	8F		
MARTINGALE RD.	12F		
MEACHAM RD.	11F		
MILTON LN.	4J		
MONTEREY AV.	7K		
NIAGARA AV.	7K		
NORTHWEST TOLLWAY	2A		
NORWELL CT.	4H		
NORWELL LN.	4H		
NORWOOD LN.	5H		

REVISED 1964
PUBLISHED BY
Sidwell Studio inc
Clear-View Maps
TELEPHONE: 28W240 NORTH AVE.
WEST CHICAGO, ILL.
Base map reproduced under license issued by the
Department of Highways, County of Cook.

19716755

BOX 615

COOK COUNTY HIGHWAY DEPT.
MAP DIVISION Room 1106

JAN 20 1966

ORDINANCE NO. 336

AN ORDINANCE ANNEXING CERTAIN TERRITORY
TO THE VILLAGE OF SCHAUMBURG

WHEREAS, a written petition under oath signed by the owners of record and electors of the territory hereinafter described has heretofore been filed with the Village Clerk of the Village of Schaumburg; and

WHEREAS, said territory is not within the corporate limits of any municipality but is contiguous to the Village of Schaumburg; and

WHEREAS, the corporate authorities of the Village of Schaumburg have determined that the annexation of said territory to the Village of Schaumburg is in the best interests of the Village of Schaumburg;

NOW, THEREFORE, BE IT ORDAINED BY THE PRESIDENT AND BOARD OF TRUSTEES OF THE VILLAGE OF SCHAUMBURG:

SECTION ONE: That the territory legally described as:

The West 3/4 of the Southwest 1/4 of the Southwest 1/4 of Section 24, Township 41 North, Range 10, East of the Third Principal Meridian, in Cook County, Illinois,

an accurate map of which territory is attached hereto and made part hereof, be and the same is hereby annexed to the Village of Schaumburg.

SECTION TWO: The Village Clerk of the Village of Schaumburg is hereby directed to file in the office of the Recorder of Deeds of Cook County, Illinois, a copy of this ordinance, together with an accurate map of the territory annexed.

SECTION THREE: This ordinance shall be in full force and effect from and after its passage and approval in the manner provided by law.

AYES: Trustees Slingerland, Wiley, Winkelhake, DeVale, Wonch and President Atcher

NAYS: None

PASSED AND APPROVED this 11th day of January, 1966.



Robert O. Atcher
Robert O. Atcher, Village President

ATTEST:

Lucille E. Dobeck
Lucille E. Dobeck, Village Clerk

STATE OF ILLINOIS }
COUNTY OF C O O K } SS

I, LUCILLE DOBECK, Clerk of the Village of Schaumburg, Cook County, Illinois, DO HEREBY CERTIFY that the attached and foregoing is a true and correct copy of an ordinance entitled "An Ordinance Annexing Certain Territory to the Village of Schaumburg," passed and approved by the President and Board of Trustees of the Village of Schaumburg, Illinois, at a meeting of said Village Board held on the 11th day of January, 1965, and the map of the annexed territory therein described.

I DO FURTHER CERTIFY that the original of which the attached and foregoing is a true and correct copy is entrusted to my care for safekeeping and is now on file in my office, and that I am the keeper of the records, ordinances, entries, resolutions, papers, books and the corporate seal of the Village of Schaumburg, Illinois.

I DO FURTHER CERTIFY that the vote upon the passage of said ordinance was taken by Ayes and Nays and so entered upon the legislative records of the Village Board of said Village of Schaumburg and that said ordinance received the necessary two-thirds (2/3) majority of the corporate authorities' vote for its adoption.

WITNESS my hand and the corporate seal of the Village of Schaumburg, Illinois, this 13th day of January, 1965.

Lucille E. Doback
VILLAGE CLERK, Village of Schaumburg